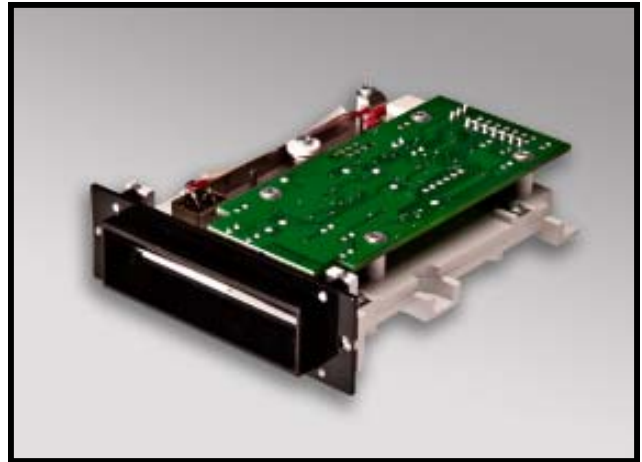
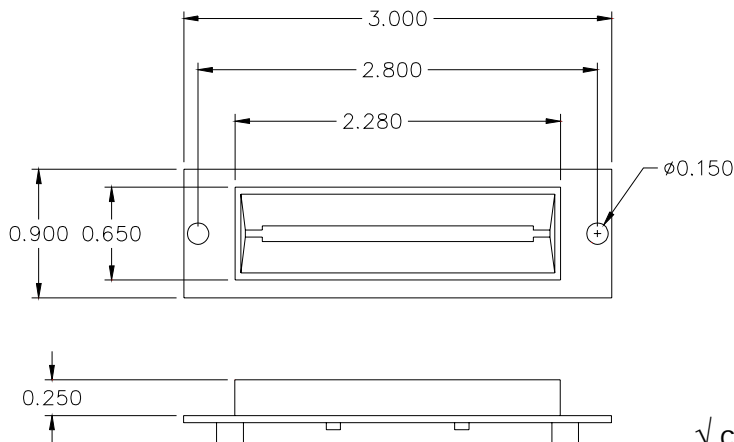

Partial Insertion Magstripe Reader**Features**

- Bit/Strobe interface
- StatGuard™ static protection
- Front and rear card detects
- Open slot architecture
- Reads ISO track1 or track2
- Easily serviceable
- One year warranty

**Model PI 60-020-BST with XS1093 bezel****Specifications**

Interface:	Bit/Strobe
Read Direction:	Insertion and/or withdrawal
Tracks:	60% of ISO Track 1 (100) or Track 2 (020)
Read Speed:	3ips - 45ips
Card Thickness:	10mils - 45mils
Connector:	1 x 7 7 pin
Dimensions:	Length: 3.5in. Width: 4.0in. Height: 1.4in. approx.
MTBF:	Electronics: 100,000 hours Head Life: 500,000 minimum
Environment:	Operating Temp.: 0°C - 50°C Storage Temp.: -20°C - 70°C Operating Humidity: 8%-95% Storage Humidity: 5% -95%

Bezel

√ custom bezels and colors available

Model PI60-100/020-BST

Model PI60-100/020-BST is a partial insertion card reader with a bit/strobe interface designed as a replacement card reader for use in player tracking systems. Antistatic features are used to insure the uninterrupted operation of the reader in casino environments, where static discharge can be problematic. The reader uses an inventive ball and optical combination for front and rear card detects that insure the card glides unhindered over the card detects. Punched cards are impossible to snag. The reader is comes with XS Technology's standard one year warranty.

Pin Assignment

1x7 7 pin

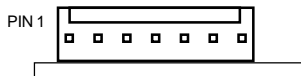

PIN	SIGNAL
1	+5V
2	-DATA Data bit Lo = Logic 1
3	-CLK Clock LO data valid
4	-DP Data present
5	-FCD Front card detect
6	-RCD Rear card detec
7	GND

Power Requirements

Voltage:	5.5V DC max. 3.0V DC min.
Current	
Reader:	30mA @ 5.0V DC 15mA @ 3.0V DC

Dimensions

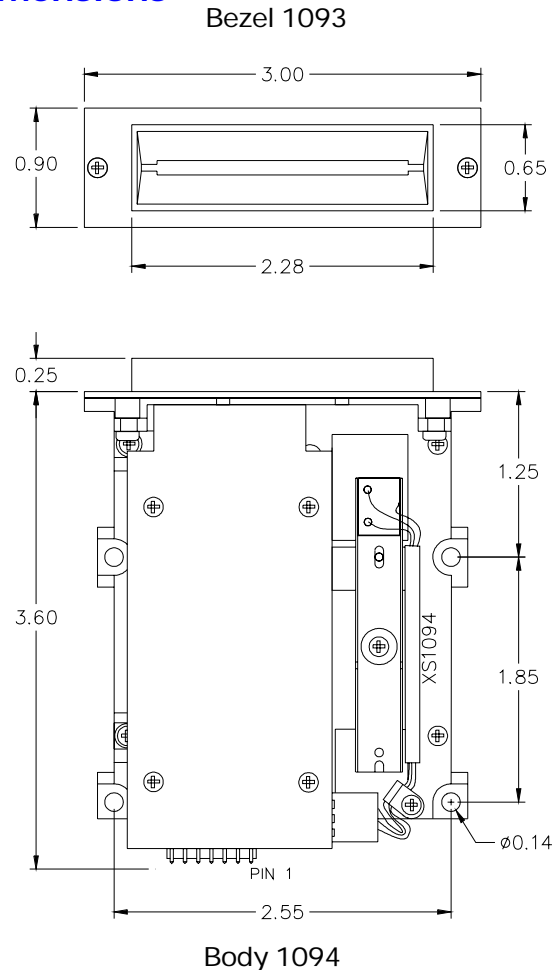

Timing Diagram

- A 2ms MIN.
- B 2/3 BIT CELL LENGTH (E)
- C 1/3 BIT CELL LENGTH (E)
- D 18.4 to 36ms

