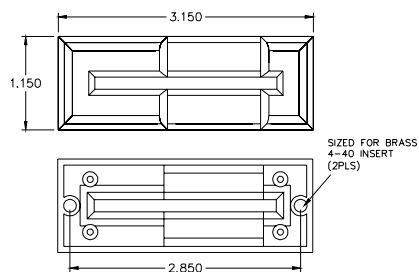

Full Insertion Magstripe Reader**Features**

- Reads bank issued credit cards
- TTL ASCII interface
- Clear plastic module
- Reads tracks one and two
- Front and rear card detects
- Open slot architecture
- Entry slot illumination
- Easily customized

**Model FI 30-120-TLA with XS1090 bezel****Specifications**

Interface:	TTL ASCII 9600 Baud, 8 Bits, 2 Stop, No Parity
Read Direction:	Insertion and/or withdrawal
Tracks:	Both ISO tracks 1 and 2
Read Speed:	3ips - 45ips
Card Thickness:	10mils - 45mils
Connector:	Series 'B' receptical
Dimensions:	Length: 3.5in. Width: 4.0in. Height: 1.4in. approx.
MTBF:	Electronics: 100,000 hours Head Life: 500,000 minimum
Environment:	Operating Temp.: 0°C - 50°C Storage Temp.: -20°C - 70°C Operating Humidity: 8%-95% Storage Humidity: 5% -95%

Bezel Selection**XS1042**

✓ custom bezels and colors available

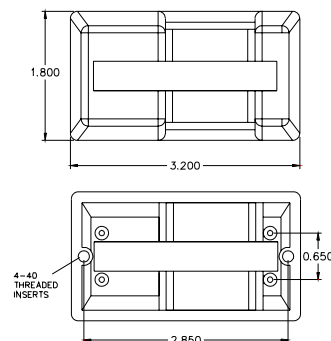
**XS1090 STANDARD**

Model FI30-120-TLA

Model FI30-120-TLA is a full insertion magnetic stripe card reader with a TTL ASCII interface. The unit is designed to read tracks 1 and 2 of encoded data on bank issued credit and financial cards. The encoded data can be read on insertion, withdrawal, or both. Direct optical front and rear card detects are standard. Mechanical front and rear card detects are available. This card reader is the industry standard for kiosks, vending machines, and gas pumps.

Unique Features

The reader uses an **inventive ball and optical combination for front and rear card detects** (option). This feature allows the reader to operate normally when translucent cards are used.

The reader's **card slot is illuminated** with super bright leds for easy identification in dimly lit locations such as casinos, arcades, bars, and night clubs. The reader's leds can be flashed on and off to alert the cardholder.

Open back architecture allows for coins and other unwanted debris to easily be pushed out the rear of the unit.

Pin Assignment

2x4 10 pin

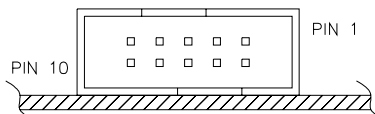

PIN	SIGNAL
1	-RESET HW reset (In)
2	TXD Transmit Data (Out)
3	RXD Receive Data (In)
4	-RTS Request To Send (Out)
5	-CTS Clear To Send (In)
6	-FCD Front Card Detect (Out)
7	GND Rear Card Detect (Out)
8	+5V Power for LEDs
9	GND
10	+5V Logic power

Power Requirements

Voltage: 5V DC +/-10%
 Current
 Reader: 50mA max.
 Lamp: 85mA typ.

Dimensions

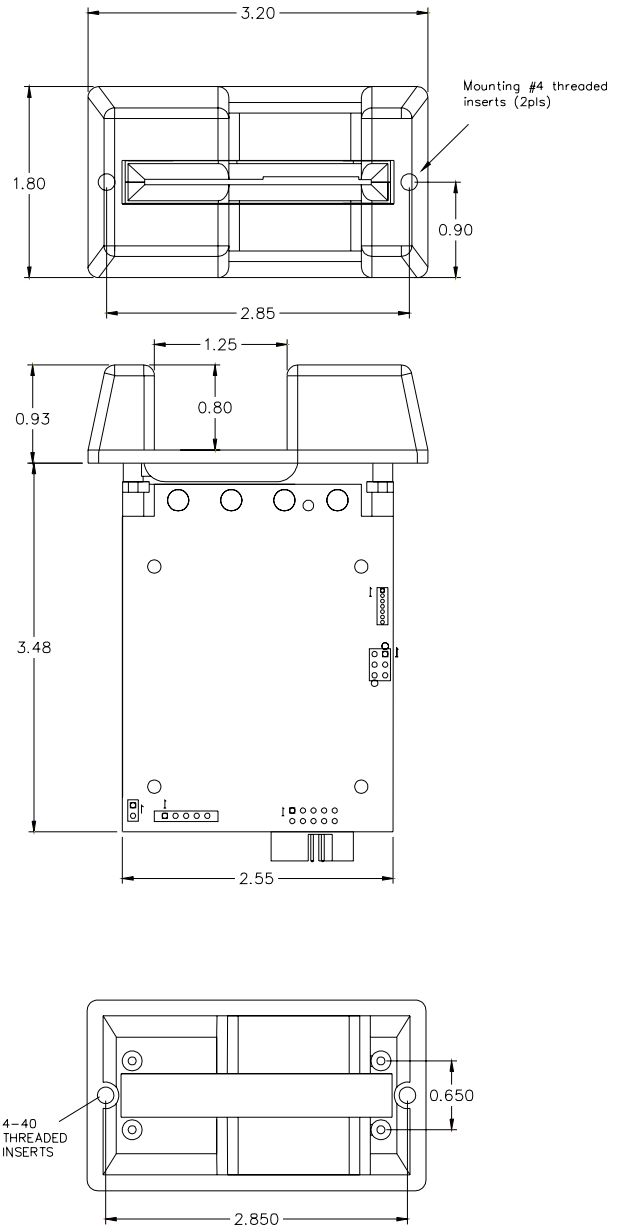

XS1090 BEZEL